

55th Street NW

Williams County Road 9

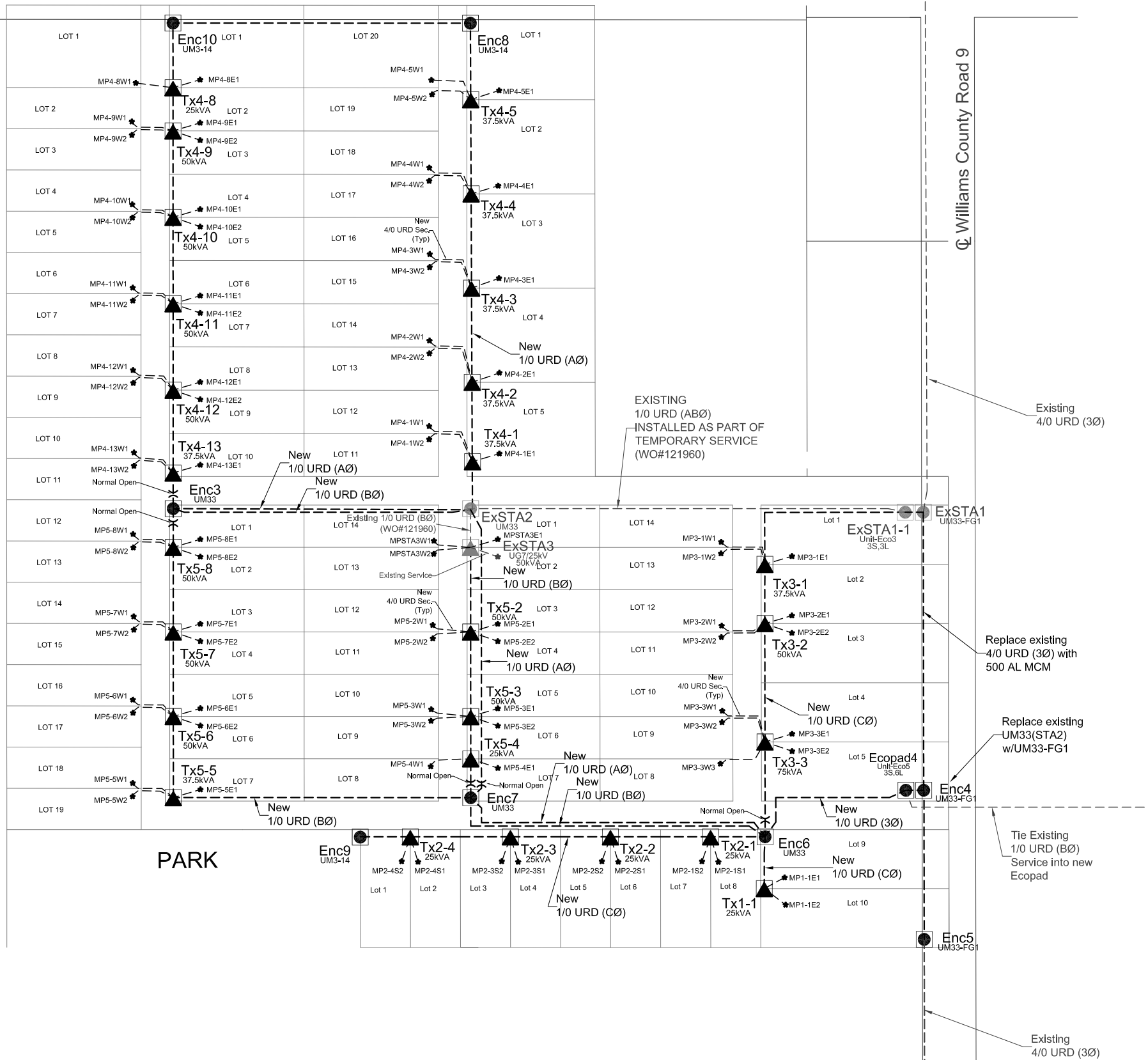

MATERIAL QUANTITY

DESCRIPTION	QTY
UM33, 3PH SECTIONALIZING ENCLOSURE	3
UM33-FG1, 3PH SECT. ENC., 600A X 200A	1
UM3-14, 1PH SECTIONALIZING ENCLOSURE	2
15 KVA, 120/240V TRANSFORMER	2
25 KVA, 120/240V TRANSFORMER	8
37.5 KVA, 120/240V TRANSFORMER	7
50 KVA, 120/240V TRANSFORMER	10
75 KVA, 120/240V TRANSFORMER	1
ECO3, 3 SOURCE, 3 LOAD ECOPAD	1
500 AL MCM, 3PH (FT)	1,200
1/0 AL URD, 3PH (FT)	50
1/0 AL URD, 1PH (FT)	15,080
4/0 TRIPLEX, SECONDARY (FT)	6,200
87 RESIDENTIAL LOTS	

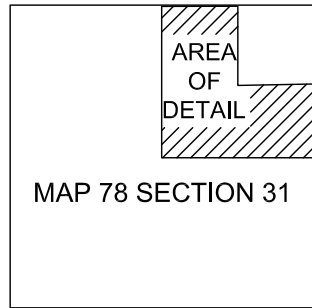

MAP 78 SECTION 31

MAP NO.: 078
TOWNSHIP: 155N
RANGE: 100W
SECTION: 32

NOTES:
1. MWEC PRIMARY AND ELECTRICAL LAYOUT FOR VISUAL REFERENCE ONLY. SEE MWEC STAKING SHEETS FOR SIZE AND QUANTITY.

2. BACKGROUND PROVIDED BY DEVELOPER FOR INSTALLATION REFERENCE.

3. ALL SECONDARY CROSSINGS TO METER PEDESTALS TO BE 4/0 TRIPLEX SECONDARY.

4. EXISTING 4/0 URD LINE LOCATION TO BE VERIFIED PRIOR TO CONSTRUCTION.



PRELIMINARY: NOT FOR CONSTRUCTION



HDR Engineering, Inc.

ISSUE	DATE	DESCRIPTION
4	10/10/12	REPLACE EX. UM33(STA2); MOVE NEW ECO
3	9/18/12	REDUNDANT FEED FROM SOUTH
2	6/13/12	MINOR EDITS
1	5/11/12	ORIGINAL DRAFT

PROJECT MANAGER	J. DOHRENDORF
PROJECT ENGINEER	S. EVERETT
DRAFTED	S. EVERETT
PROJECT NUMBER	177361.019



MOUNTRAIL-WILLIAMS ELECTRIC COOP
WILLISTON, NORTH DAKOTA

BLACKWOOD SUBDIVISION
(WO#120949)



FILENAME		SHEET
SCALE	NTS	